

Heated front and rear seats with and without heated steering wheel

From model year 2001

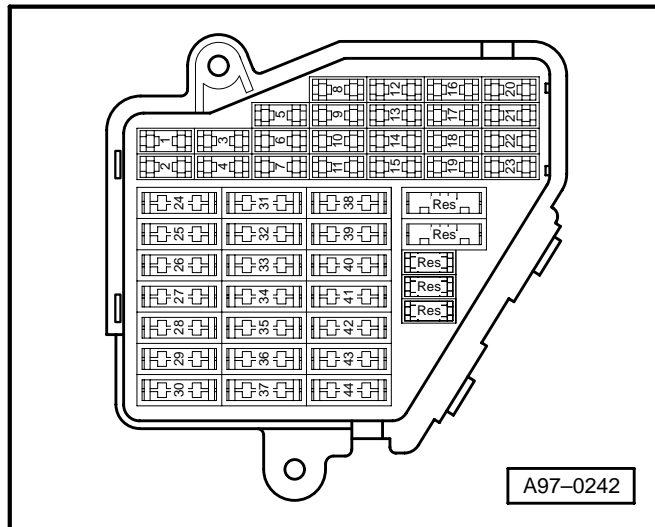

Fuse box

- ◆ Dash panel, driver's side

Fuse colours

- 30 A - green
- 25 A - white
- 20 A - yellow
- 15 A - blue
- 10 A - red
- 7.5 A - brown
- 5 A - beige

Note:

From fuse number 23 upwards the fuses in the fuse box are designated as 223 etc. in the Current Flow Diagram.

4-point relay carrier with screw connection

- ◆ Dash panel, driver's side

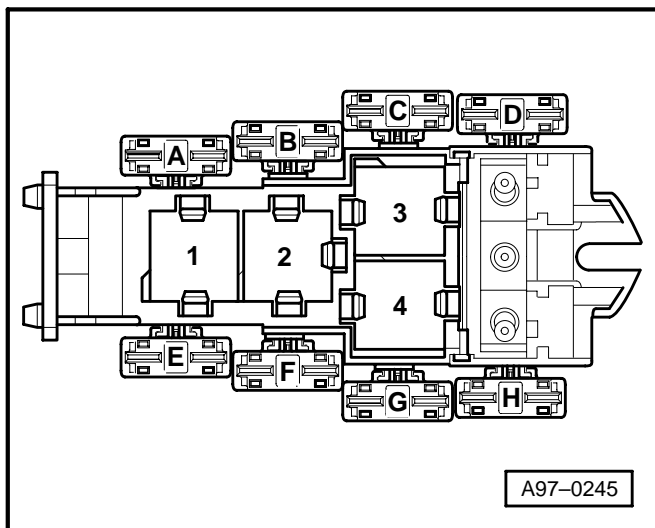

www.car60.cc

Fuses

- D - Ignition/starter switch
- S5 - Fuse in fuse box/relay plate
- S244 - Fuse in fuse box
- 501 - Screw connection -2- (30), on relay plate
- A2 - Positive (+) connection (15), in dash panel wiring harness
- A32 - Positive (+) connection (30), in dash panel wiring harness
- A52 - Positive (+) connection -2- (30), in dash panel wiring harness
- A74 - Connection (15a, fuse 5), in dash panel wiring harness
- O1 - Positive (+) connection (30), in heated seats wiring harness

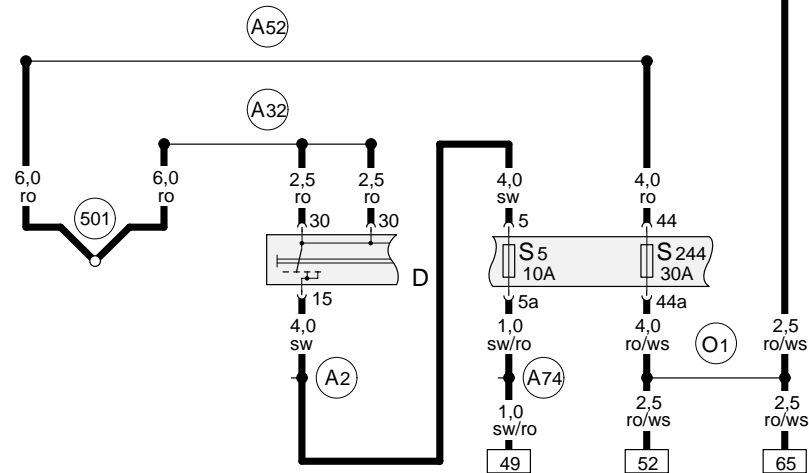

ws = white
sw = black
ro = red
br = brown
gn = green
bl = blue
gr = grey
li = purple
ge = yellow
or = orange

www.car60.cc

Heated driver's seat

- E87 - Control and display unit for air conditioner/Climatronic
 G59 - Driver's seat temperature sensor
 J527 - Steering column electronics control unit
 T2g - 2-pin connector, on driver's seat for heated backrest
 T6d - 6-pin connector, green, connector point, seat wiring, driver's seat
 T8f - 8-pin connector, on driver's seat for heated seat cushion
 T16a - 16-pin connector, black, on steering column electronics control unit
 Z6 - Heated driver's seat cushion
 Z7 - Heated driver's seat backrest
 Z31 - Driver's seat cushion lateral support heater
 Z36 - Heated steering wheel

- (81) - Earth connection -1-, in dash panel wiring harness
 (96) - Earth connection -1-, in seat heating wiring harness
 (244) - Earth connection (sender earth), in Climatronic wiring harness
 A146 - Connection (convenience CAN bus, high), in dash panel wiring harness
 A147 - Connection (convenience CAN bus, low), in dash panel wiring harness

- * - Both possible
 ** - Only models with heated steering wheel

ws = white
 sw = black
 ro = red
 br = brown
 gn = green
 bl = blue
 gr = grey
 li = purple
 ge = yellow
 or = orange

www.car60.cc

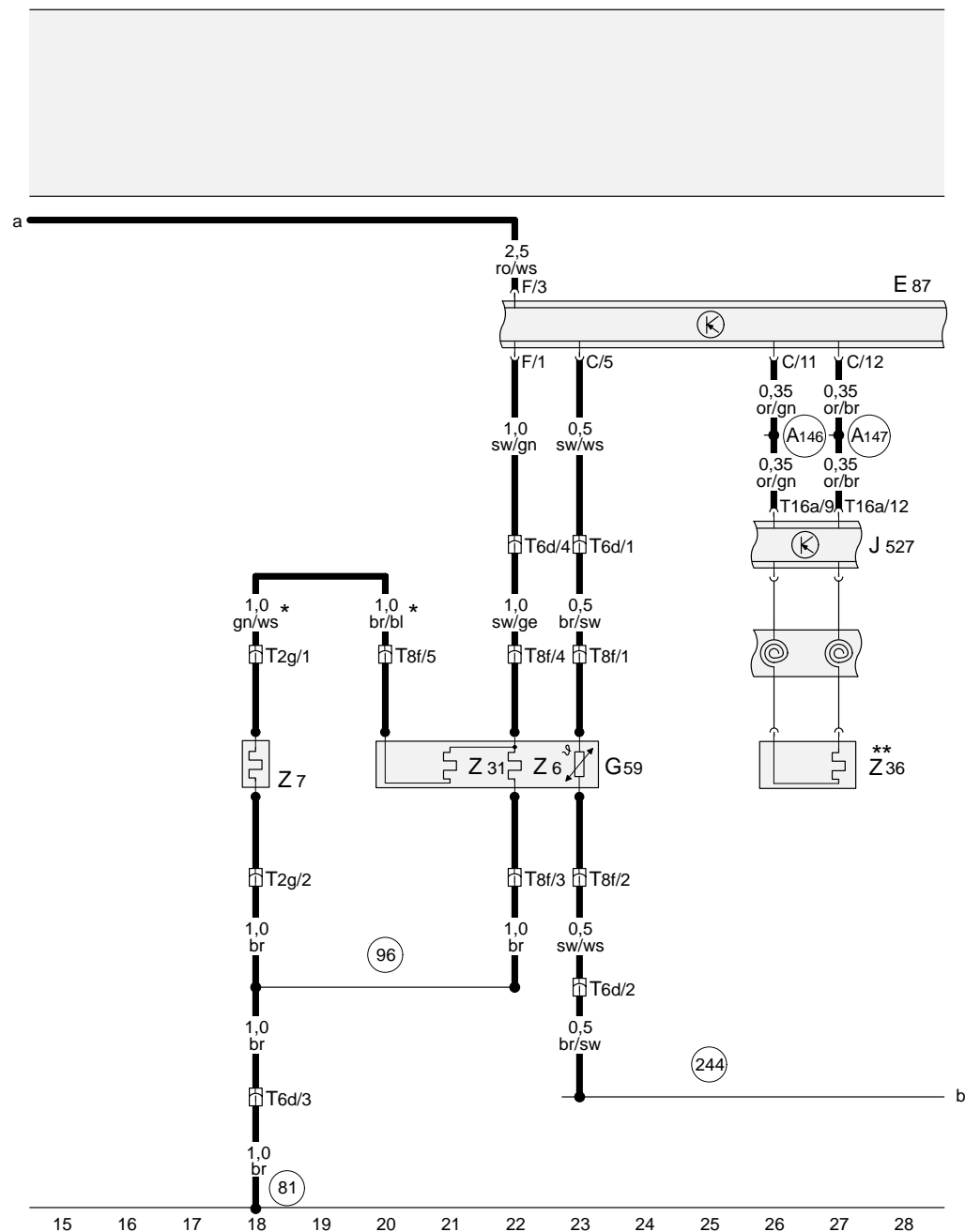

97-55504

Heated front passenger's seat

- E87 - Control and display unit for air conditioner/Climatronic
 G60 - Front passenger's seat temperature sensor
 G150 - Left vent temperature sender
 G151 - Right vent temperature sender
 T2h - 2-pin connector, on front passenger's seat for heated backrest
 T6e - 6-pin connector, green, connector point, seat wiring, front passenger's seat
 T8g - 8-pin connector, on front passenger's seat for heated seat cushion
 Z8 - Heated front passenger's seat cushion
 Z9 - Heated front passenger's seat backrest
 Z33 - Front passenger's seat lateral support heater

- (136) - Earth connection -2-, in seat heating wiring harness
 (244) - Earth connection (sender earth), in Climatronic wiring harness
 (249) - Earth connection -2-, in interior wiring harness

* - Both possible

ws = white
 sw = black
 ro = red
 br = brown
 gn = green
 bl = blue
 gr = grey
 li = purple
 ge = yellow
 or = orange

www.car60.cc

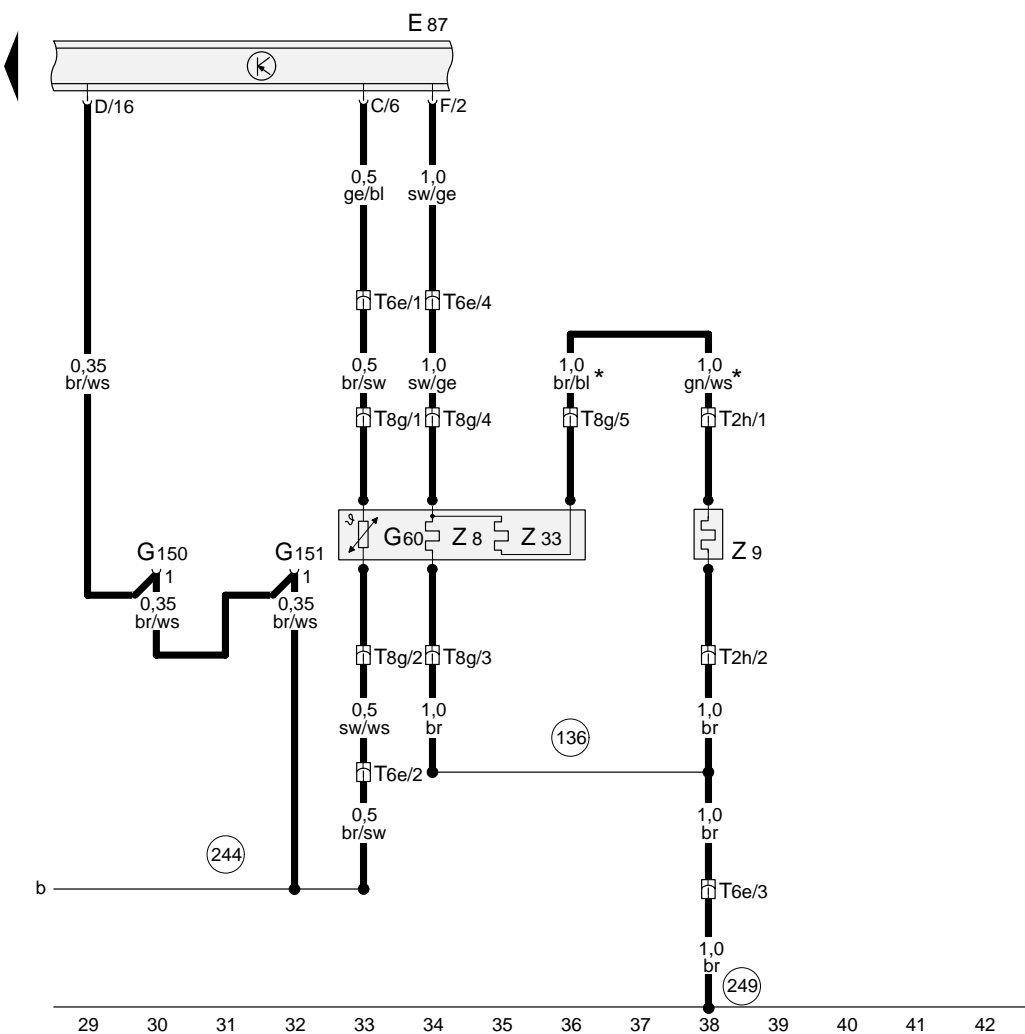

97-55505

Heated rear seat, left

- E128 – Heated rear left seat switch with regulator
- G94 – Rear left seat temperature sensor
- G177 – Rear seat occupied sensor, driver's side
- J215 – Heated rear left seat control unit
- J285 – Control unit with display in dash panel insert
- L44 – Seat heating switch light bulb
- T2i – 2-pin connector, heated rear seat backrest, left
- T6g – 6-pin connector, on rear left seat
- T12f – 12-pin connector, black, under rear seat bench
- T32a – 32-pin connector, green, on dash panel insert
- Z10 – Heated rear seat, left
- Z11 – Heated rear seat backrest, left

- (249) – Earth connection -2-, in interior wiring harness
- (A175) – Connection (58s), in dash panel wiring harness

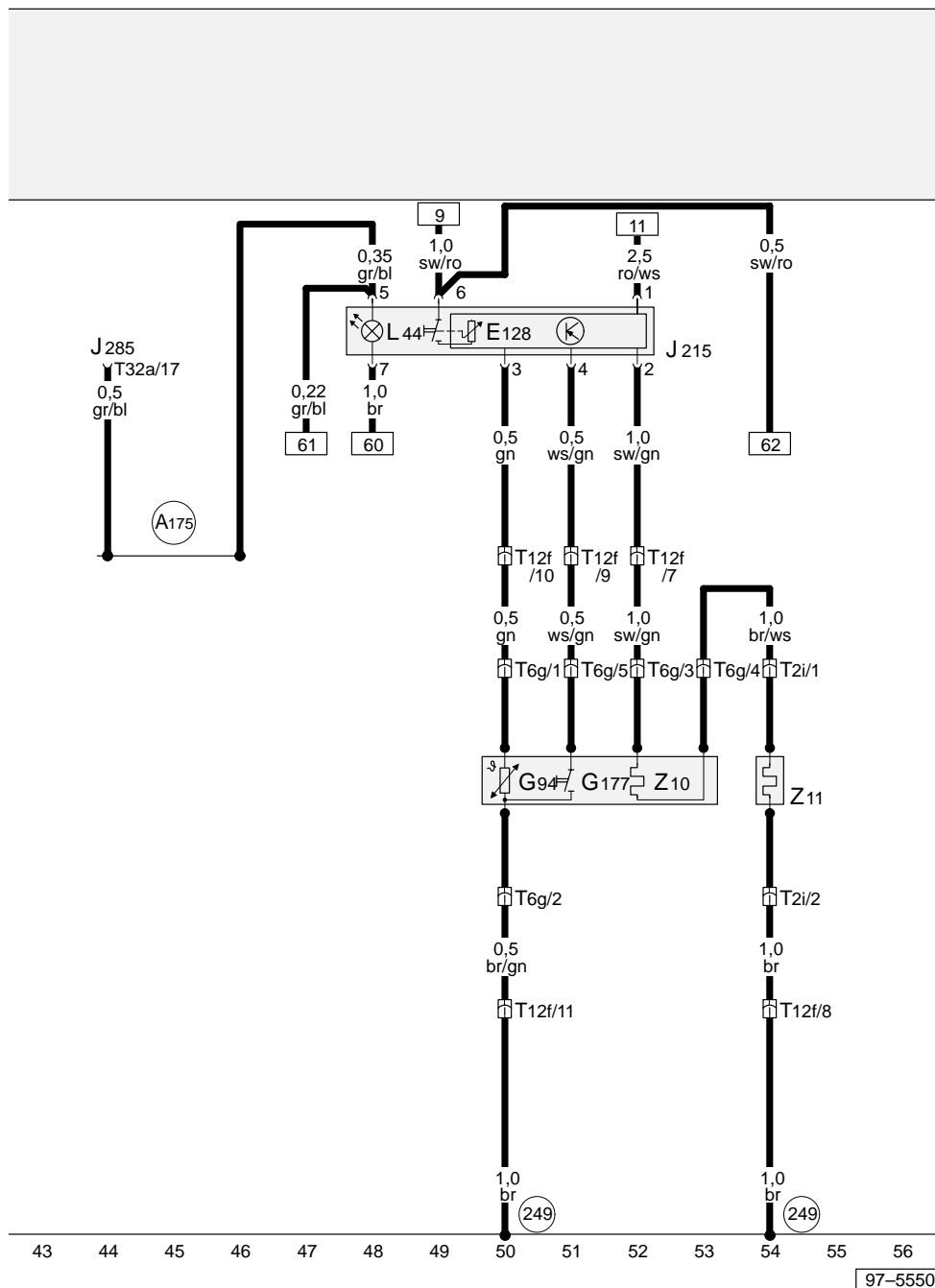

ws = white
 sw = black
 ro = red
 br = brown
 gn = green
 bl = blue
 gr = grey
 li = purple
 ge = yellow
 or = orange

97-55506

Heated rear seat, right

- E129 – Heated rear right seat switch with regulator
 G95 – Rear right seat temperature sensor
 G178 – Rear seat occupied sensor, front passenger's side
 J216 – Heated rear right seat control unit
 L44 – Seat heating switch light bulb
 T2j – 2-pin connector, heated rear seat backrest, right
 T6h – 6-pin connector, on rear right seat
 T12f – 12-pin connector, black, under rear seat bench
 Z12 – Heated rear seat, right
 Z13 – Heated rear seat backrest, right

(249) – Earth connection -2-, in interior wiring harness

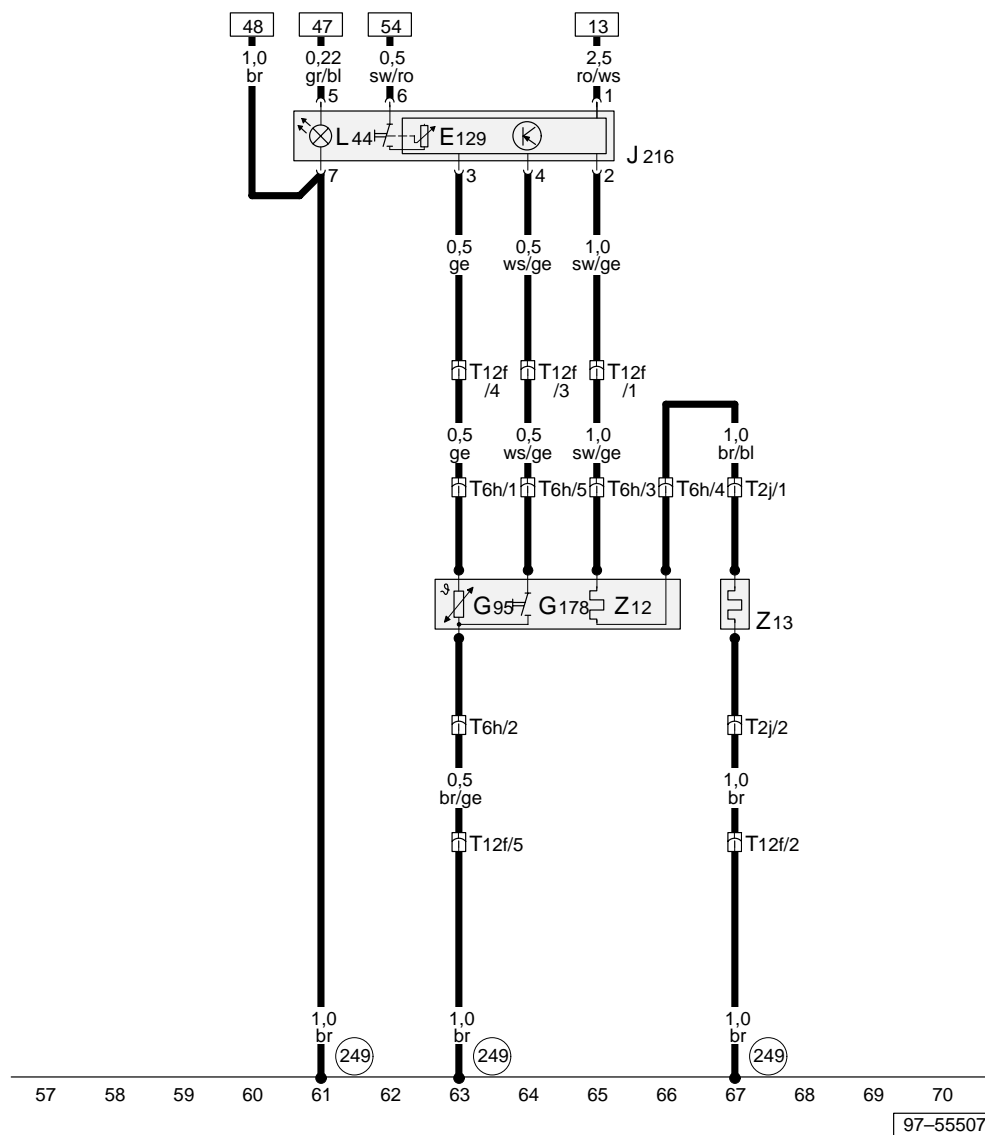

ws = white
 sw = black
 ro = red
 br = brown
 gn = green
 bl = blue
 gr = grey
 li = purple
 ge = yellow
 or = orange

www.car60.cc